

OB-1 Pro Roaster

INSTRUCTIONS

Thank you for purchasing OB-1 Pro: the smart coffee roaster. This product provides the adjustable functions of firepower, airflow and rotating speed, also supporting hands-free for full-auto roasting. Before attempting to install the product, please read and heed all instructions in detail. For further information, please scan the QR-Code to check the website.



Official website

Parts Name

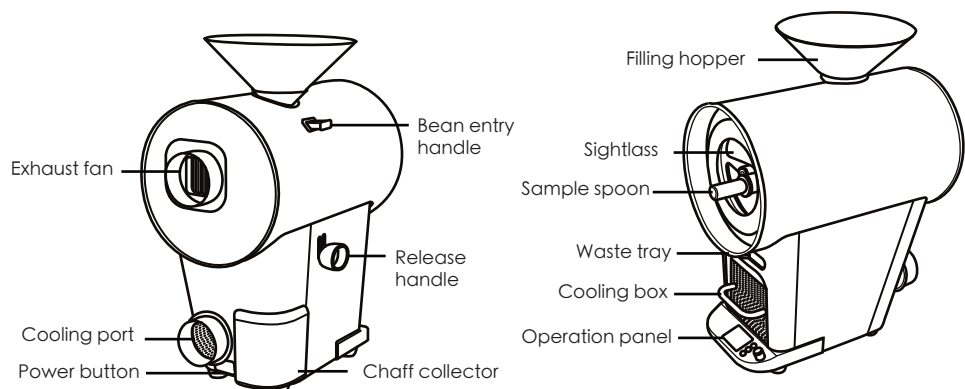

Product Specifications

Model	OB-1 Pro	Weight	35 kg
Dimensions	H 610 x W 310 x D 510 mm (H 700mm including filling hopper)		
Roasting capaci-	3~ 4 pots per hour	Recommended	5 hours per day
Batch size	Per time 300 g ~ 1200 g		
Roasting time	6 ~ 20 mins (1kg beans first crack in 8 mins)		
Connection method	APP communicates via Bluetooth (Compatibility: iOS / Android)		
Inner pot	Thickness: 2 mm, SUS304		
Glass	Food grade soda-lime glass (>400° C)		
Heating method	Indirectly heated	Bean box capaci-	1.2 kg
Voltage	AC 220V ~ 230V	Max power	3300 W
Firepower	0~ 10 level	Rotating speed	50 ~ 90 RPM
Airflow	0~ 15 level	Origin	China

★ For more product details, please scan the QR-Code to check on the website.



NCC Regulatory information

For low-power RF equipment that has obtained the certification certificate, the company, the firm or the user shall not change the frequency or increase the power without approval or change the features and functions of the original design. The use of low-power radio frequency equipment shall not affect flight safety and interfere with legitimate communications; When interference is found, it should be stopped immediately, and improved to no interference before continuing to use. The aforesaid lawful communications refer to radio communications operated in accordance with the provisions of the Telecommunications Management Act. Low-power radio frequency devices are subject to interference from legitimate communications or industrial, scientific and medical electrical equipment radiated by electrical equipment.

Important Safety Instruction



While using appliances, all safety precautions and instructions should be followed. Improper operation may cause personal and property damage, even life-threatening!

- This product can be used by children aged 8 years and above and persons with physical, sensory or mental impairments, provided that they have accepted the necessary use and knowledge of this product and understand the hazards that may be involved.

- Children less than 8 years of age shall be kept away unless continuously supervised. Make sure that children under 8 years of age do not play with the product and keep the product and its cord out of the reach of children.
- Children are not allowed to clean and maintain without supervision.
- If the supply cord is damaged, it must be replaced by the manufacturer, its service agent or similarly qualified persons in order to avoid a hazard.
- This product is not intended for use by persons (including children) with reduced physical, sensory or mental abilities or lack of experience and knowledge, unless there is supervision or instruction regarding the use of this product by a person responsible for their safety.
- This product is for household and shops use only.

Do not disassemble

Disassemble or modify the product without the party's liability may lead to failure or accidents, and the product warranty will be lost. If there is a fault, please contact the customer service staff for repair.

Safe operation environment

- Do not place this product on an unstable surface, non-heat-resistant, flammable materials (such as curtains), heating appliances, electric heaters, gas stoves, etc., to avoid fire.
- Do not cause product to heavy fall, or it may malfunction or break the panel and glass door, resulting in injury.
- Only suitable for connection to the voltage of 220V ~ 230V, please follow the product's power specifications.
- If there is no alternative but to obtain an extension lead, it must be capable of a load of 3300W or even more, and do not use other high-powered devices (such as ovens, microwave ovens, dehumidifiers, etc.) at the same time, or it may cause accidents due to power failure.
- For each house electric pressure atability, user can obtain a suiteable voltage stabilizer for assistance.
- Do not use this apparatus near water, humid environment or outdoors to avoid the risk of short circuit damage or electric shock.
- When using this product, be sure to have a grounding wire to prevent leakage of electricity.

Beware of high temperature

- During the roasting process, the metal casing, the end of the sample spoon and waste tray are at high temperature. Please do not touch the casing and the front door or draw out the tray.
- The product is marked with a warning sticker on the upper cover, and the maximum temperature may reach more than 100° C, please do not touch it.
- Before you attempt to clean ensure the apparatus has cooled down below 50° C, to avoid scald.



Operating safety precautions

- Roast only coffee beans in this product.
- Do not roast beans continuously for more than 5 hours, or the life of the machine will be shortened.
- Do not leave the machine while using this product. The appliance and its accessible parts become hot during use. Care should be taken to avoid touching heating elements.
- While using the APP mode, do not leave the roasting operation page or perform other tasks during roasting progress, or the machine will send out "Beep!Beep!" warning sound. After 30 seconds, if the operation page have no return, it will auto-switch to manual roasting.
- When the bean temperature reaches the first 10 degrees of the maximum safety limit of 235° C, the machine will emit a "beep! Beep!"Warning sound and force the beans to cool at 235° C. Do not let the temperature of the roasted beans exceed 235° C, or it may cause the coffee beans to catch fire and cause an accident.
- After use, please properly clean up the chaff and ash in the waste tray and the sliver skin in the chaff collector box to avoid the risk of ash in fire.
- Do not put your hands into the air outlet when the machine is in operation, or the high-speed rotating wind wheel will cause injury.
- That appliance is not intended to be operated by means of an external timer or separate remote-control system.
- Accessible parts may become hot during use. Young children should be kept away.

Emergency treatment of power failure / Enforcing a manual bean extraction process



If the roaster suddenly loses power during the roasting process, the coffee beans in the boiler will burn and catch fire! Please follow the following procedure immediately to manually force the beans out to prevent the beans from burning. Please keep an electrical fire extinguisher near the roaster and extinguish the fire immediately in case of any fire.

- Take out the hexagonal wrench in the accessory box, insert the hexagon hole in front of the front door bearing, and drive the drum counterclockwise to rotate continuously until the cooked beans are completely discharged to the cooling bean box.

- Manually pull up the handle of the bean dispenser and hold it on.

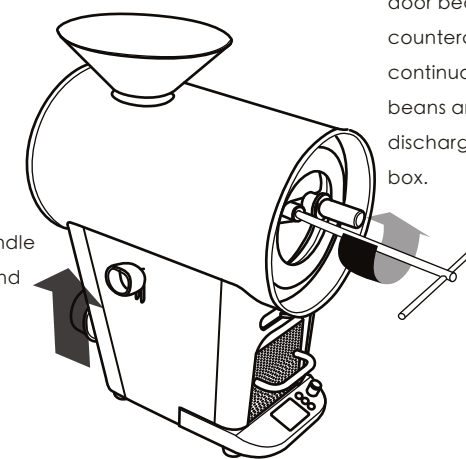

WEEE Regulatory information



- Do not dispose of this product (electrical and electronic equipment) as unsorted garbage.
- Please contact your local government for information on the available recycling system.
- If this product is disposed of in a landfill or dump, harmful substances may leak into groundwater and enter the food chain, harming your health and well-being.
- When replacing an old device with a new one, the retailer is legally obligated to take back your old device for disposal at least free of charge.

Quick Start Guide

Settings

- Plug the power cord into a 220V socket (The withstand current of socket and circuit is more than 20A · Be sure to plug in and ground! In case of electricity leakage!) , and assemble the hopper, sample spoon, waste tray, chaff collector and bean box in position.
- Plug the Cooling fan module to a 220V socket. Connect the signal line to the corresponding jack of the machine. (Be sure to plug in and ground! In case of electricity leakage!)
- Turn on the machine and it will perform a self-test procedure (about 20 seconds). If there is any abnormal signal, please refer to the abnormal warning comparison table on the official website.

Roaster settings

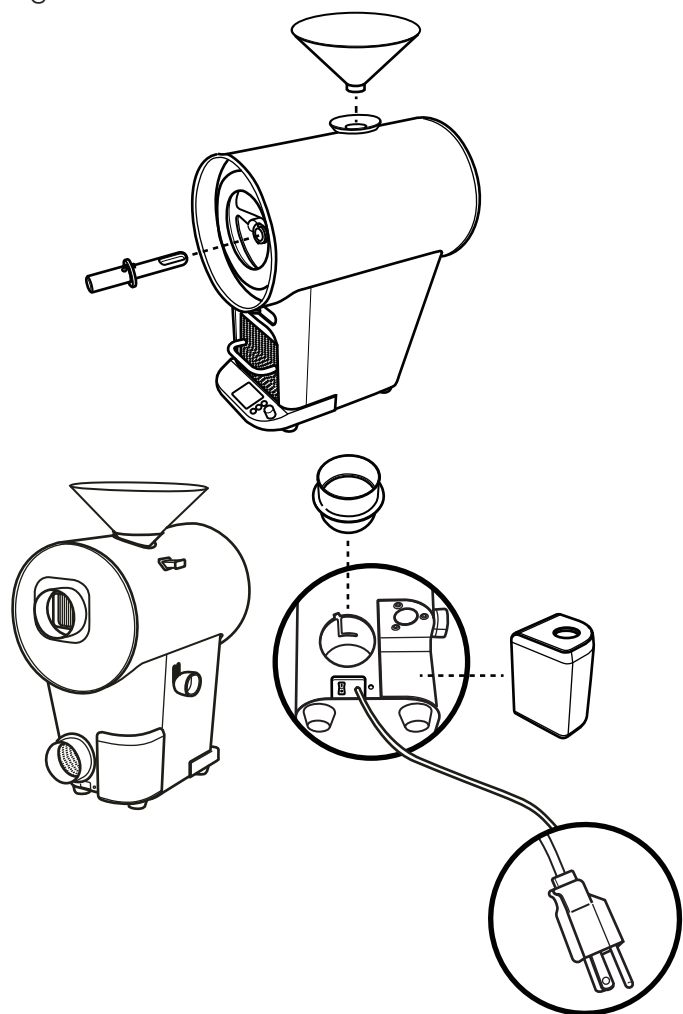

220V socket
Be sure to plug in and ground! In case of electricity leakage!

Cooling fan module settings

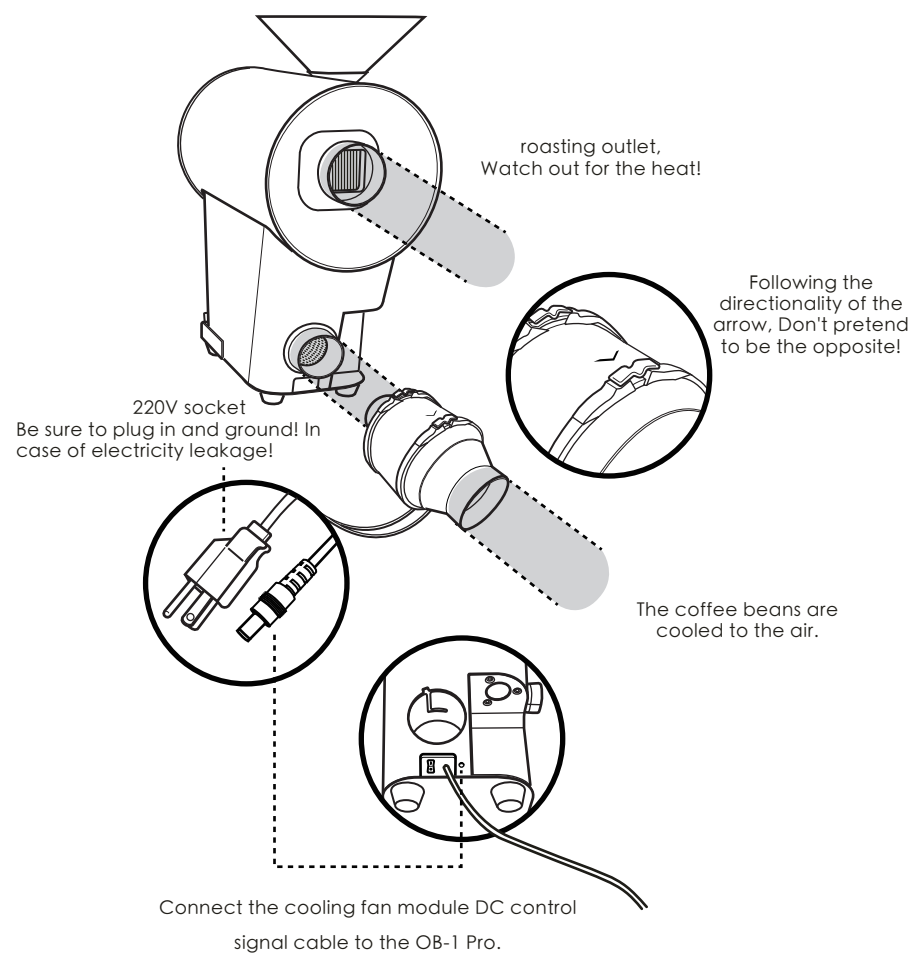

Local roasting

The roaster can be operated via rotating the knob beside operation panel to select and adjust. Press the knob to confirm.

Manual mode

1. Mode selection: Select "Manual" in the main menu to enter manual roasting.
2. Preheating setting: Set the preheating target temperature and select whether to autoloading the beans then use the knob to select and press "Start" to auto-preheat. You can also select "Skip" to enter manual preheating.
3. Preheating success:
 - (1) Autoload On: After preheating success, autoloading beans.
 - (2) Autoload Off: After preheating success, the roaster will send out "Beep! Beep!" warning sound and stay "Ready" until 3 mins later; in this stage, please manually pull the entry handle to start roasting, or it will auto-start the cooling process.
4. Roasting:
 - (1) While the roasting process, you can adjust the force of firepower, airflow and rotating speed by the quick selection button and the knob. ★ For 1.2 kg roasting, the recommended firepower is 7~10, and the recommended airflow is 0~8.
 - (2) During the roasting process, you can rotate the knob to lock the Event area of the LCD screen, and press to record the time of the roasting state such as 1st crack.
5. Beans release & Cooling: Use the knob to select and press "Unload" or manually pull up the handle to release the coffee beans. If the "cooling fan module" has installed already, it will automatically conduct the bean cooling process.
6. Finished: Select and press "Stop" to terminate the roaster and beans cooling process.
 - ★ If the roasting is over, it is recommended to cool down below 50° C before shutting down.

Automatic mode

1. Mode selection: Select "Auto" from the main menu to enter the profile selection page. Select the pre-used Profile to roast automatically.
 - ★ The roaster has 10 profile temporary storage spaces, it can be uploaded to the APP pre-temporary profile.
2. Preheating success: Same as the manual mode.
3. Roasting, Beans release & Cooling: Auto operation.
4. Finished: Same as the manual mode.

APP roasting

Support iOS and Android devices. Automatically record the roasting data and save as a profile.

Bluetooth connection settings

1. In the main menu of the machine, select the "Bluetooth" symbol in the lower left corner to enter pairing search.
2. Download and install the latest Orbiter Roaster APP on the device, click the main menu in the upper left corner of the APP and enter the "ROAST" page, and click the roaster you want to connect to pair.

Manual mode

1. Mode selection: After connected, select "Manual" to enter manual roasting.
2. Preheating setting: Set the preheating target temperature and select whether to autoloading the beans then press "start" to auto preheating or to select "skip" to manual preheating.
3. Preheating success:

After the preheating is succeeded, the beans will be added automatically. During the preheating process, you can also pull the bean knob at any time to force the beans in.
4. Roasting:
 - (1) Roasting operation page: Present Beans Temperature (red curved), Air Temperature (while curve) and each Rate of Rise (ROR).
 - (2) During the roasting process, the force of firepower, airflow rotating speed are adjustable. Also, a long press on the "Event" can take photo of beans and record the figures of the event.
5. Beans release & Cooling: When the roasting comes to an end, press the "Unload" which is on the up-right of APP page or pull the machine release handle to conduct unload process. If the "cooling fans module" has installed already, it will automatically conduct the bean cooling process.

6. Saving: After roasting, the system will ask whether to add this roasting history as an auto-roasting selection in Profile. Also, the roasting data from the history page can be chosen and be added to Profile.
7. Finished: Press "Bean Cooling off" to finish the cooling process. If not, the system will turn off automatically after 5 mins.

Automatic mode

1. Mode selection: On the "Roast" page, select the pre-stored Profile roast curve to enter the preheating settings.
2. On the preheating setting page, select PID temperature control/parameter copying. (PID temperature control: PID fire is used to control the temperature of the beans during the roasting process, so that the bean temperature reaches the set temperature of the profile.) Parameter copying: Completely copy the operating parameters of the profile, and adjust the firepower, damper, and drum speed during the process. Click "Start" to start the automatic warm-up process.
3. Roasting, Beans release, Cooling: With the selected Profile setting, the process from roasting to cooling can be completed automatically.
4. Finished:
 - (1) Select "Continue with the same Profile" to roast constantly.
 - (2) Select "End this roasting" to finish roasting.

Cleaning & Maintenance

Basic maintenance

1. Regularly keep the chaff collector empty (Recommended: every 3kg roasting volumes need to remove the contents once) to avoid stuck chaff causing fire.
2. It is recommended to remove the cooked beans from the cooled bean box at the end of each pot of roasting, and then clean the dust and debris from the waste tray (Waste tray high temperature! Be careful with burns.), to avoid the risk of ash on fire.

Deep cleaning

1. Turn the power off and remove the plug before cleaning to avoid accidents caused by electric shock.
2. Ensure the apparatus has cooled down before cleaning to avoid scald.
3. Clean the appearance with dry cloth, and do not expose the machine to moisture.
4. You can take out the waste tray, use a blow gun to blow air inward from the gap in the waste tray to force out the dust, and then use a dust suction to clean the dust.
5. By removing 6 screws on the front door and the internal LED cable, the roller and the sightglass can be taken out to clean (be careful to handle the glass and the roller to avoid the risk of breakage and deformation). The inner cavity of the machine can also be cleaned.
6. You can remove 4 screws of the exhaust fan and inner hexagon set screw of the centrifugal fan, and take out the fan for cleaning.

Warranty Notice

- Warranty Period: One year from the purchase date.
- Failed to follow these safety precautions and instructions, the maintenance fees may be charged even within the warranty period.
- Please check the warranty registration within 7 days after receiving the product.
- For full warranty rule, registration support and warranty service information, please scan QR-code to check on the website.

*For complete product warranty notice, please refer to the Traditional Chinese or Simplified Chinese version of the instructions.

